



2336 DIVISADERO STREET, SAN FRANCISCO
STYLISH PACIFIC HEIGHTS VICTORIAN





Enjoying a superb Pacific Heights address, this classic Victorian is the perfect blend of refined grace and stately character from its circa 1900 heritage now combined with modern luxury. The three-level residence, with entrance elevated from the street, proudly portrays many original details such as high ceilings, fine hardwood floors, classic millwork and molding, and stained glass accents. Remodeling includes a reconfigured floor plan for today's style of living plus sophisticated and stylish design elements throughout. Nowhere is this more apparent than in the tremendous kitchen and family room combination. Here, a vast skylight, sliding glass doors to the walk-out gardens and patios, plus a chef's kitchen with Carrara marble counters and stainless steel appliances blend for an inviting venue that is certain to be the home's central gathering place.

Upstairs there are three bedrooms and a large bathroom (with plans/drawings for an additional bath). Each room is spacious and bright, as is the bathroom with its added benefit of a skylight. Enhancing the accommodations is a separate, privately located 1-bedroom, 1-bath apartment with street-level access making it ideal for guests, an office, or for rental income. Rounding out the appeal of this special home is a huge garage with tandem parking for 3 to 4 cars plus beautiful walk-out gardens and brick patios for outdoor enjoyment. All of this, plus a location less than one block to Alta Plaza Park, just a few blocks to boutique shopping and fine dining, and four blocks to the greenbelts of the Presidio, a 1,500-acre national park – the ultimate setting for distinguished City living.





Summary of the Home

- Light-filled single-family Victorian with a private apartment for guests, office, or rental
- 3 bedrooms and 2.5 baths in the main residence plus 1-bedroom, 1-bath apartment
- Approximately 2,808 total square feet (per floor plan developer)
- Desirable Pacific Heights neighborhood close to Town School and University High School and one block to Alta Plaza Park for tennis and recreation
- Excellent Walk Score of 93 and Transit Score of 82
- Elevated front entrance to true divided light front doors with beveled edge glass and transom window
- Classic foyer highlights many of the home's original Victorian appointments – extensive millwork with carved details, fine hardwood flooring, and stained glass window in the staircase
- Formal living room with bay window topped with a single hue of stained glass divided lights; a fireplace is outlined in marble and a ceiling medallion recalls the home's heritage
- Grand-scale formal dining room features original carved corbels, sconce lighting, and two ceiling medallions; a fireplace is outlined in marble
- Beautifully updated kitchen with Carrara marble counters, including a large island with counter seating; a glass-paned door opens to a small deck and steps down to the garage and apartment
- Stainless steel appliances include a Frigidaire 5-burner gas cooktop, GE microwave and oven, Samsung dishwasher, and KitchenAid refrigerator
- Fully open to the kitchen, the family room has a large skylight, entire wall of brick, plus wide sliding glass doors to the walk-out gardens
- Full bath off the family room with single-sink vanity and tub with overhead shower
- Upstairs master bedroom with fireplace, stained glass bay window, and two closets; two additional bedrooms, one with Dutch door for fresh air
- Large upstairs full bath has a tub, shower, and single-sink vanity, and skylight
- Tremendous garage with tandem parking for 3 to 4 cars and laundry area with LG washer and Kenmore dryer

- Private apartment with outside, street-level entrance has a living area with garden views, kitchen with gas range and mini refrigerator, bedroom, and bathroom with shower
- Other features include: security alarm and wine storage
- Landscaped garden with brick patios and mature plantings directly accessed from family room
- Expansion possibilities, see listing agent for additional information



Upper Level



Main Level

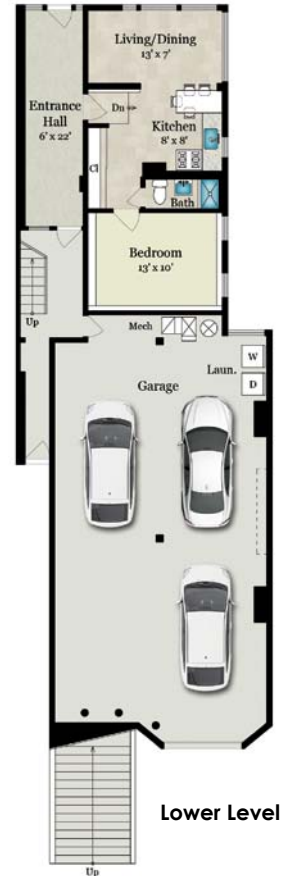

Lower Level

Offered at \$3,350,000

For additional photos please visit:

www.2336Divisadero.com

The information contained herein, including square footage or acreage, has been provided, by various sources which may include the seller, public records, MLS or others. Pacific Union has not verified or investigated the accuracy of this information. Prospective buyers are advised to conduct their own investigation of the property and the information contained herein, utilizing licensed professionals where appropriate, before purchasing this property. ©Marketing Designs, Inc. 650.802.0888 • marketingdesigns.net